

STAINLESS STEEL BALL BEARING INSERTS

UC STANDARD DUTY SET SCREW TYPE

- Wide inner ring bearing
- All Stainless Steel
 - Balls & Rings: 440
 - Retainer & Slinger: 302
 - Set Screws: 304
- Lubrication groove with hole on set screw side
- Additional oil hole on opposite side
- Anti-rotation device
- Lubricated with NSF H1 Registered Food Grade Grease

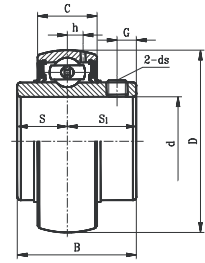

Bearing No.	Shaft Dia. d		Dimension (in) (mm)								Basic load rating (lb)		Weight (lb)
	(in.)	(mm)	D	B	C	S	S ₁	G	h	D _s	Dynamic	Static	
SSUC201-8	1/2												0.48
SSUC202-10	5/8		1.8540	1.2205	0.6299	0.5000	0.7205	0.1850	0.1732	1/4-28UNF	2827	1494	0.44
SSUC204-12	3/4		47	31.0	16	12.7	18.3	4.7	4.4	M6X1			0.40
SSUC204		20											0.37
SSUC205-14	7/8		2.0472	1.3386	0.6693	0.5630	0.7756	0.2165	0.1693	1/4-28UNF	3147	1771	0.51
SSUC205		25	52	34.0	17	14.3	19.7	5.5	4.3	M6X1			0.46
SSUC205-16	1												0.44
SSUC206-18	1-1/8		2.4409	1.5000	0.7480	0.6260	0.8740	0.2165	0.1969	1/4-28UNF	4383	2517	0.75
SSUC206		30	62	38.1	19	15.9	22.2	5.5	5.0	M6X1			0.71
SSUC206-19	1-3/16												0.68
SSUC206-20	1-1/4												0.66
SSUC207-20	1-1/4		2.8346	1.6890	0.7874	0.6890	1.0000	0.2559	0.2283	5/16-24UNF	5777	3416	1.16
SSUC207-22	1-3/8		72	42.9	20	17.5	25.4	6.5	5.8	M8X1			1.05
SSUC207		35											1.03
SSUC207-23	1-7/16												0.99
SSUC208-24	1-1/2		3.1496	1.9370	0.8268	0.748	1.1890	0.3150	0.2480	5/16-24UNF	6654	4091	1.49
SSUC208		40	80	49.2	21	19.0	30.2	8.0	6.3	M8X1			1.41
SSUC209-28	1-3/4		3.3465	1.9370	0.8661	0.7480	1.1890	0.3150	0.2677	5/16-24UNF	7159	4675	1.54
SSUC209		45	85	49.2	22	19.0	30.2	8.0	6.8	M8X1			1.50
SSUC210-31	1-15/16		3.5433	2.0315	0.9055	0.7480	1.2835	0.3543	0.2559	3/8-24UNF	7890	5215	1.81
SSUC210		50	90	51.6	23	19.0	32.6	9.0	6.5	M10X1.25			1.76
SSUC210-32	2												1.72
SSUC211-32	2		3.9370	2.1890	0.9843	0.8740	1.3150	0.3543	0.2835	3/8-24UNF	9790	6564	2.79
SSUC211		55	100	55.6	25	22.2	33.4	9.0	7.2	M10X1.25			2.46
SSUC211-35	2-3/16												2.42
SSUC212-36	2-1/4		4.3307	2.5630	1.0630	1.000	1.5630	0.4134	0.3228	3/8-24UNF	10745	7373	3.67
SSUC212		60	110	65.1	27	25.4	39.7	10.5	8.2	M10X1.25			3.36
SSUC212-39	2-7/16												3.19

* Stainless Steel Narrow Inner Ring Inserts (SB) and Eccentric Locking Collar Style Inserts (HC & SA) may also be available. Consult Factory.

