



ABT BEARING

GT Series

Ball Thrust Bearing

Inch Dimensions
Grooved Races
Single Acting
Flat Seat

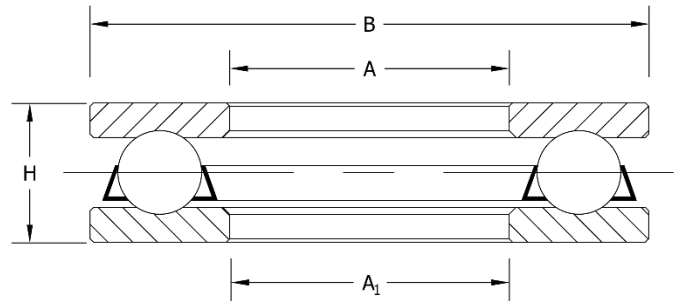

BEARING NUMBER	A		B	H		BALLS		LOAD RATING (lbs.)		SPEED LIMIT	BEARING WEIGHT Lbs.
	+0.002 -0.000	+0.010 -0.010		+0.000 -0.003	+0.005 -0.005	No.	SIZE	Static	Dynamic		
GT5	.753	.781	1.469	.563	14	3/16	3150	600	6400	.163	
GT6	.816	.844	1.469	.563	14	3/16	3150	600	6400	.150	
GT7	.878	.906	1.844	.625	12	1/4	4792	940	5400	.274	
GT8	.941	.969	1.844	.625	12	1/4	4792	940	5400	.266	
GT9	1.003	1.031	1.969	.625	12	1/4	4792	914	5200	.303	
GT10	1.006	1.094	1.969	.625	12	1/4	4792	914	5200	.288	
GT11	1.128	1.156	2.094	.625	14	1/4	5591	991	5000	.294	
GT12	1.191	1.219	2.094	.625	14	1/4	5591	991	5000	.313	
GT13	1.253	1.281	2.344	.625	17	1/4	6789	1085	4800	.400	
GT14	1.316	1.344	2.344	.625	17	1/4	6789	1085	4800	.394	
GT15	1.378	1.406	2.469	.625	17	1/4	6789	1085	4750	.431	
GT16	1.441	1.469	2.469	.625	17	1/4	6789	1085	4750	.413	
GT17	1.503	1.531	2.594	.625	18	1/4	7188	1087	4550	.463	
GT18	1.566	1.594	2.594	.625	18	1/4	7188	1087	4550	.445	
GT19	1.628	1.656	2.969	.813	16	5/16	9985	1543	3650	.825	
GT20	1.691	1.719	2.969	.813	16	5/16	9985	1543	3650	.813	
GT21	1.753	1.781	3.094	.813	16	5/16	9985	1543	3570	.881	
GT22	1.816	1.844	3.094	.813	16	5/16	9985	1543	3570	.828	
GT23	1.878	1.906	3.219	.813	20	5/16	12481	1737	3550	.945	
GT24	1.941	1.969	3.219	.813	20	5/16	12481	1737	3550	.906	
GT25	2.003	2.031	3.344	.813	18	3/8	16168	2349	3500	.953	



ABT BEARING

GT Series

GT Series – Ball Thrust Bearing - Continued

BEARING NUMBER	A	A ¹	B	H	BALLS		LOAD RATING (lbs.)		SPEED LIMIT	BEARING WEIGHT Lbs.
	+0.002 -0.000	+0.010 -0.010	+0.000 -0.003	+0.005 -0.005	No.	SIZE	Static	Dynamic		
GT26	2.066	2.094	3.344	.813	18	3/8	16168	2349	3500	.969
GT27	2.128	2.156	3.594	.813	18	3/8	16168	2295	3350	1.078
GT28	2.191	2.219	3.594	.813	18	3/8	16168	2295	3350	1.063
GT29	2.253	2.281	3.719	.813	18	3/8	16168	2295	3300	1.156
GT30	2.316	2.344	3.719	.813	18	3/8	16168	2295	3300	1.125
GT31	2.378	2.406	3.844	.813	18	3/8	16168	2295	3250	1.165
GT32	2.441	2.469	3.844	.813	18	3/8	16168	2295	3250	1.125
GT33	2.503	2.531	3.969	.813	22	3/8	16168	2295	3200	1.196
GT34	2.566	2.594	3.969	.813	22	3/8	19760	2601	3200	1.375
GT35	2.628	2.656	4.344	1.000	18	7/16	22016	3104	2750	1.907
GT36	2.691	2.719	4.344	1.000	19	1/2	22016	3104	2750	1.875
GT37	2.753	2.781	4.469	1.000	20	1/2	31950	4302	2700	1.875
GT38	2.816	2.844	4.469	1.000	20	1/2	31950	4302	2700	1.938
GT39	2.878	2.906	4.594	1.000	20	1/2	31950	4302	2670	2.047
GT40	2.941	2.969	4.594	1.000	20	1/2	31950	4302	2650	1.946
GT41	3.003	3.031	4.719	1.000	20	1/2	28755	3775	2630	2.078



Materials: Rings and balls are constructed of thru-hardened 52100 steel. Retainer is pressed steel.